

Duo – Adding A New Device

Congrats on your new device, now let's make sure it's Duo enabled and ready for use!

Step 1 – Login & Access Settings

Visit mfagw.una.edu and login with your UNAPortal username and password. You will then be presented with a Duo authentication prompt. Click “My Settings & Devices.”

*Note – if you have selected “Remember this device for 30 days,” you will be unable to access your settings in this particular browser. If you do need to access your Duo settings, try logging in through another web browser.

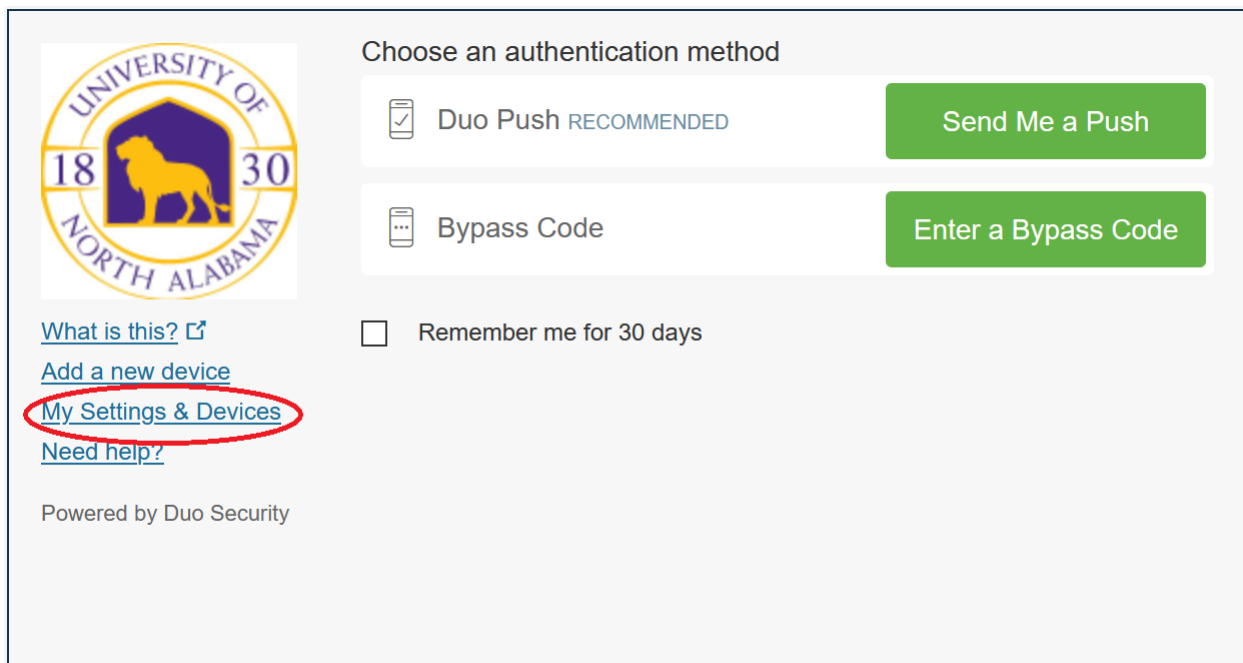

UNIVERSITY OF
18 30
NORTH ALABAMA

Choose an authentication method

Duo Push RECOMMENDED [Send Me a Push](#)

Bypass Code [Enter a Bypass Code](#)

Remember me for 30 days

[What is this? ↗](#)
[Add a new device](#)
[My Settings & Devices](#)
[Need help?](#)

Powered by Duo Security

Step 2 – Confirm

Before accessing your settings, Duo will need to confirm that you are an authorized user. Duo can send you a push notification or you can use a bypass code obtained via text message from the Duo app.

UNIVERSITY OF NORTH ALABAMA 18 30

My Settings & Devices

First, we need to confirm it's really you. Choose an authentication method below to manage your settings and devices.

Choose an authentication method

- Duo Push **RECOMMENDED** [Send Me a Push](#)
- Bypass Code [Enter a Bypass Code](#)

[What is this?](#) [Add a new device](#) [My Settings & Devices](#) [Need help?](#)

Powered by Duo Security

Step 3 – Add another device

Once you have verified your identity, you will be presented with this screen where you can click “Add another device”

UNIVERSITY OF NORTH ALABAMA 18 30

My Settings & Devices

- iOS [Device Options](#)
- [+ Add another device](#)

Default Device: iOS

When I log in:

[Back to Login](#) [Saved](#)

[What is this?](#) [Add a new device](#) [My Settings & Devices](#) [Need help?](#)

Powered by Duo Security

Step 4 – Select the device type

Select the type of device that you wish to add. For this example, we choose a tablet.



UNIVERSITY OF
18 30
NORTH ALABAMA

[What is this?](#) [Add a new device](#)
[My Settings & Devices](#)
[Need help?](#)

Powered by Duo Security

What type of device are you adding?

Mobile phone RECOMMENDED

Tablet (iPad, Nexus 7, etc.)

Landline

Continue

Step 5 – Select type

Select the type of tablet or phone that you are adding.



UNIVERSITY OF
18 30
NORTH ALABAMA

[What is this?](#) [Add a new device](#)
[My Settings & Devices](#)
[Need help?](#)

Powered by Duo Security

What type of tablet are you adding?

iOS (iPad, iPod Touch)

Android

Back **Continue**

Step 6 – Install the Duo app on your device.

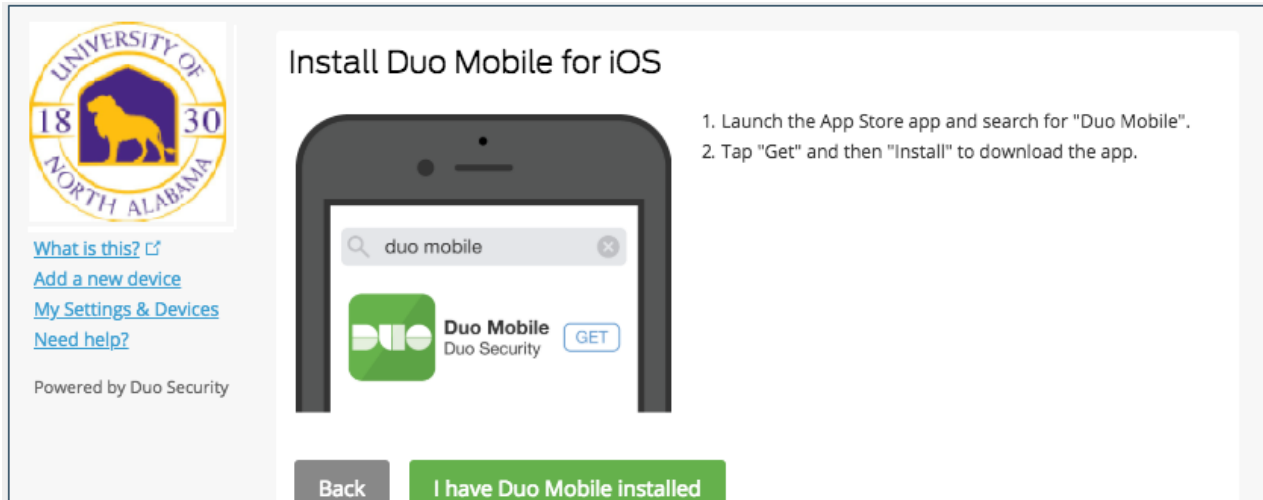

Step 7 – Activate the app.

Once you've installed the app on your smartphone, open the app and activate it by following the on screen prompts.

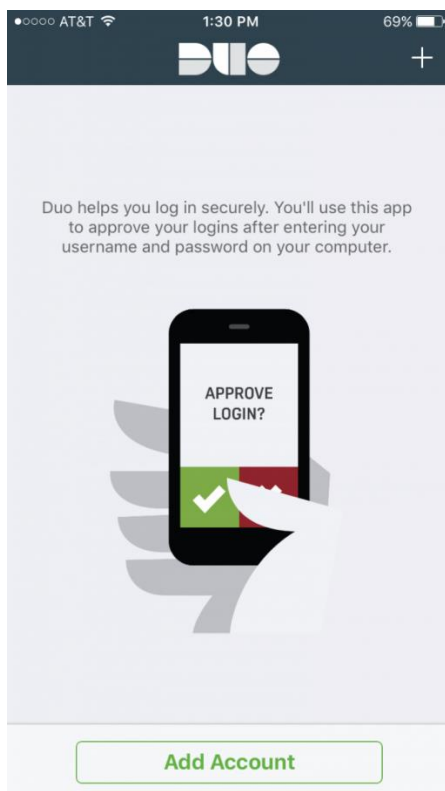

Step 8 – Use the built in scanner to activate.

Simply hold your device up to your computer screen.

UNIVERSITY OF NORTH ALABAMA
18 30

[What is this?](#)
[Add a new device](#)
[My Settings & Devices](#)
[Need help?](#)

Powered by Duo Security

Activate Duo Mobile for iOS

1. Open Duo Mobile.
2. Tap the "+" button.
3. Scan this barcode.

[Or, have an activation link emailed to you instead.](#)

Back Continue

Step 9 – Success

You'll receive a success message. Click continue, and make sure that the "When I log in" field is set to "Ask me to choose an authentication method."

UNIVERSITY OF NORTH ALABAMA
18 30

[What is this?](#)
[Add a new device](#)
[My Settings & Devices](#)
[Need help?](#)

Powered by Duo Security

iOS Device Options

iOS JUST ADDED Device Options

+ Add another device

Default Device: iOS

When I log in: Ask me to choose an authentication method

Saved Continue to Login

You're done! Click save, and if necessary, continue to login where you will be able to login to your account through your new Duo enabled device.